

SAN DIEGO COUNTY
DEPARTMENT OF
HEALTH
AND HUMAN SERVICES

HARBORSIDE PARK

CITY OF CHULA VISTA

PARK REDEVELOPMENT BUBBLE DIAGRAM - PHASE I

Deneen Powell Ateller, Inc.
 TEL: 619.234.8042 2306 EL CAMINO BLVD.
 FAX: 619.234.8028 SAN DIEGO, CA 92104
 www.dpa.com

4.11.23

ACTUAL NORTH
PLAN NORTH

SCALE: 1" = 20'-0"

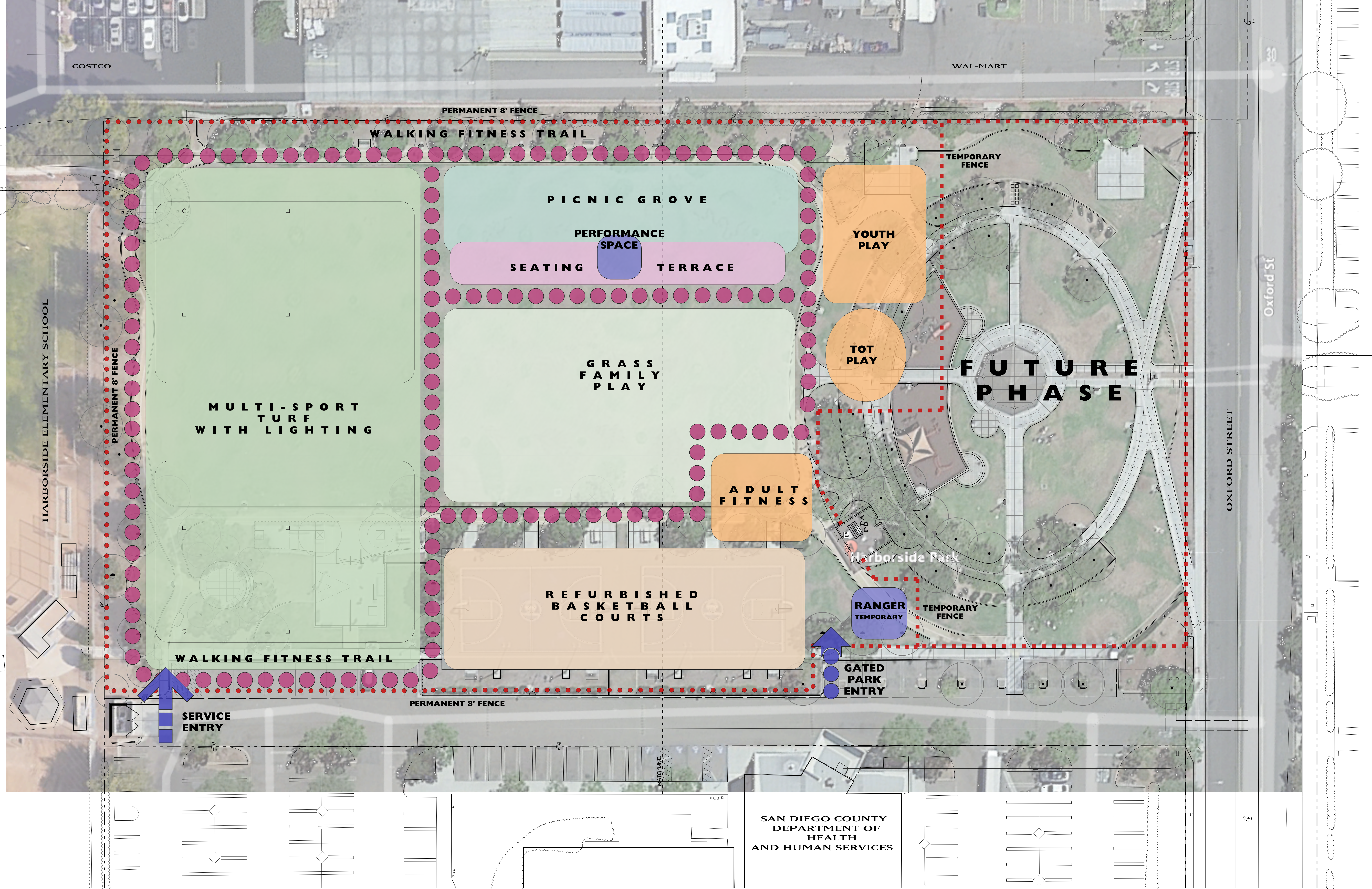

HARBORSIDE PARK
CITY OF CHULA VISTA
PARK REDEVELOPMENT BUBBLE DIAGRAM - PHASE 2

SAN DIEGO COUNTY
 DEPARTMENT OF
 HEALTH
 AND HUMAN SERVICES

Deneen Powell Ateller, Inc.
 TEL: 619.234.8042 3306 EL CAMINO BLVD.
 FAX: 619.234.8028 SAN DIEGO, CA 92104
 www.dpai.com

4.11.23

ACTUAL NORTH
 PLAN NORTH

SCALE: 1" = 20'-0"

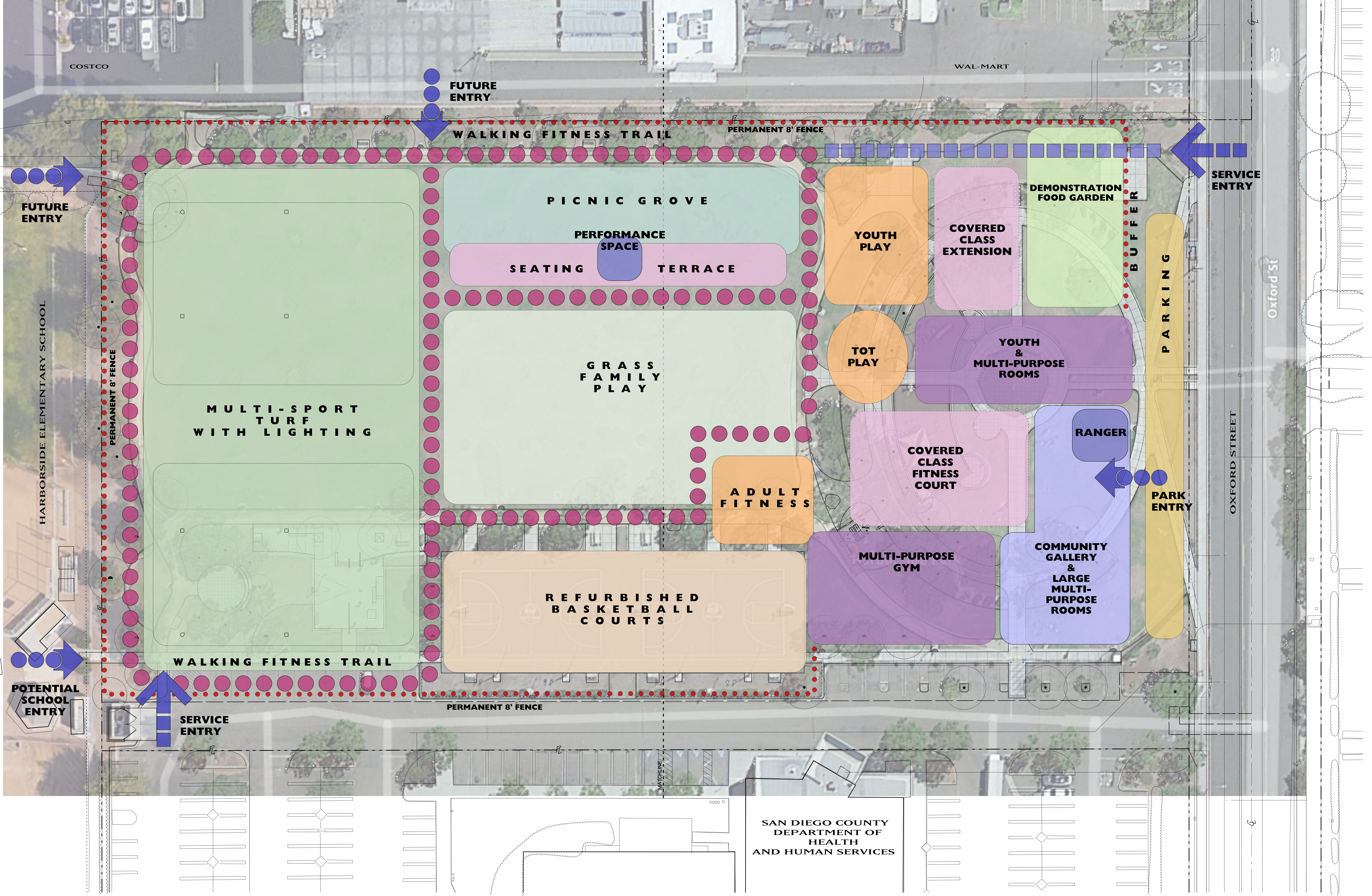

HARBORSIDE PARK
CITY OF CHULA VISTA
PARK REDEVELOPMENT BUBBLE DIAGRAM - PHASE 3

SAN DIEGO COUNTY
 DEPARTMENT OF
 HEALTH
 AND HUMAN SERVICES

Deneen Powell Ateller, Inc.
 TEL: 619.234.8042 3306 EL CAMINO BLVD.
 FAX: 619.234.8028 SAN DIEGO, CA 92104
 www.dpa.com

4.11.23

ACTUAL NORTH
 PLAN NORTH

SCALE: 1" = 20'-0"