

PROPOSED BOUNDARIES OF COMMUNITY FACILITIES DISTRICT NO. 16-M (EL DORADO RIDGE)

CITY OF CHULA VISTA
COUNTY OF SAN DIEGO
STATE OF CALIFORNIA

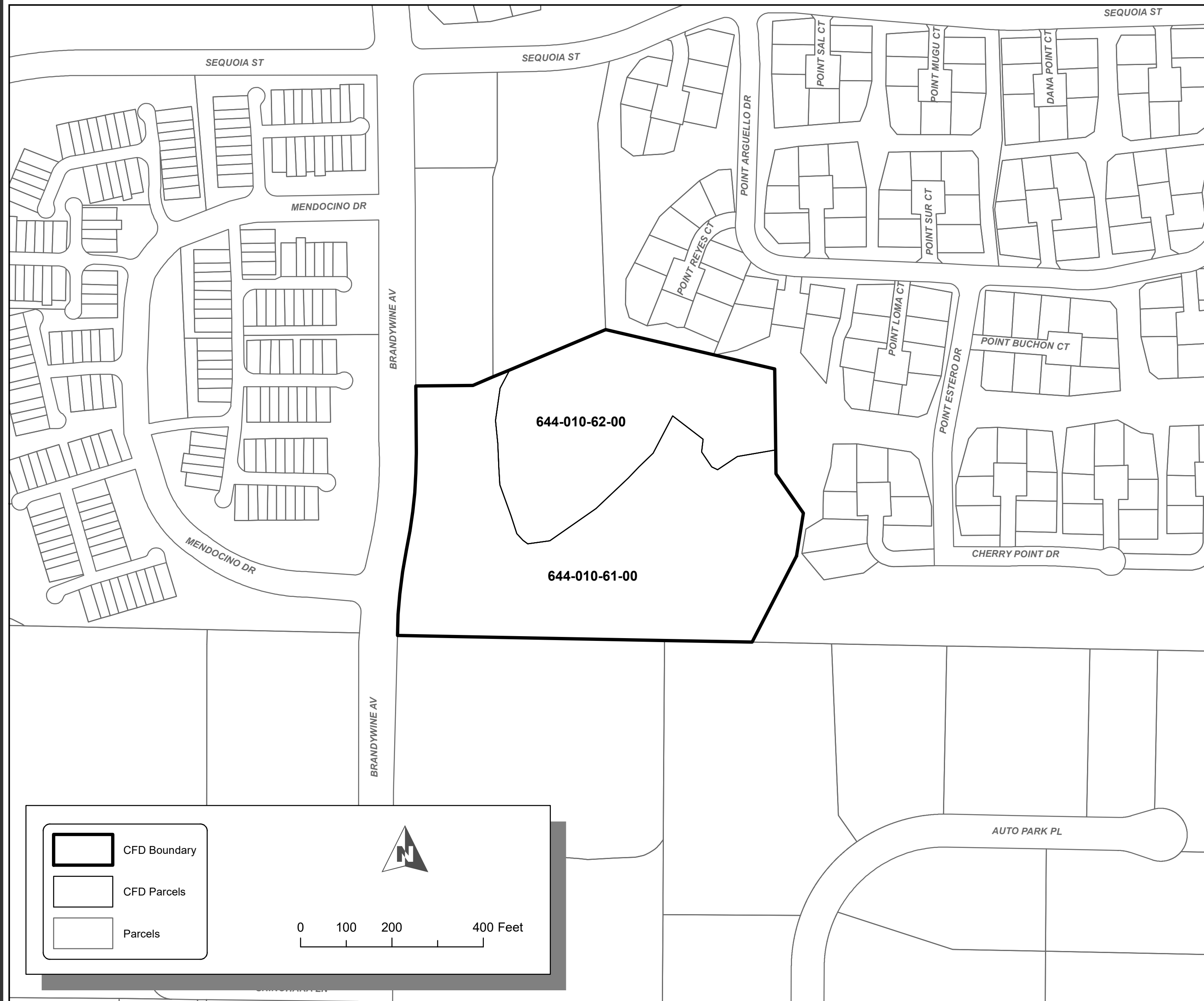

FILED IN THE OFFICE OF THE CITY CLERK THIS ____ DAY OF _____, 20__.

CITY CLERK
CITY OF CHULA VISTA

I HEREBY CERTIFY THAT THE WITHIN MAP SHOWING PROPOSED BOUNDARIES OF COMMUNITY FACILITIES DISTRICT NO 16-M (EL DORADO RIDGE), CITY OF CHULA VISTA, COUNTY OF SAN DIEGO, STATE OF CALIFORNIA, WAS APPROVED BY THE CITY COUNCIL OF THE CITY OF CHULA VISTA AT A REGULAR MEETING THEREOF, HELD ON THE ____ DAY OF _____, 20__, BY ITS RESOLUTION NO. _____.

CITY CLERK
CITY OF CHULA VISTA

FILED THIS ____ DAY OF _____, 20__, AT THE HOUR OF ____ O'CLOCK __M, IN BOOK _____ OF MAPS OF ASSESSMENT AND COMMUNITY FACILITIES DISTRICTS AT PAGE _____, IN THE OFFICE OF THE COUNTY RECORDER IN THE COUNTY OF SAN DIEGO, STATE OF CALIFORNIA.

COUNTY RECORDER OF
COUNTY OF SAN DIEGO

FOR PARTICULARS OF THE LINES AND DIMENSIONS OF ASSESSOR PARCELS, REFERENCE IS MADE TO THE MAPS OF THE ASSESSOR, COUNTY OF SAN DIEGO, STATE OF CALIFORNIA.

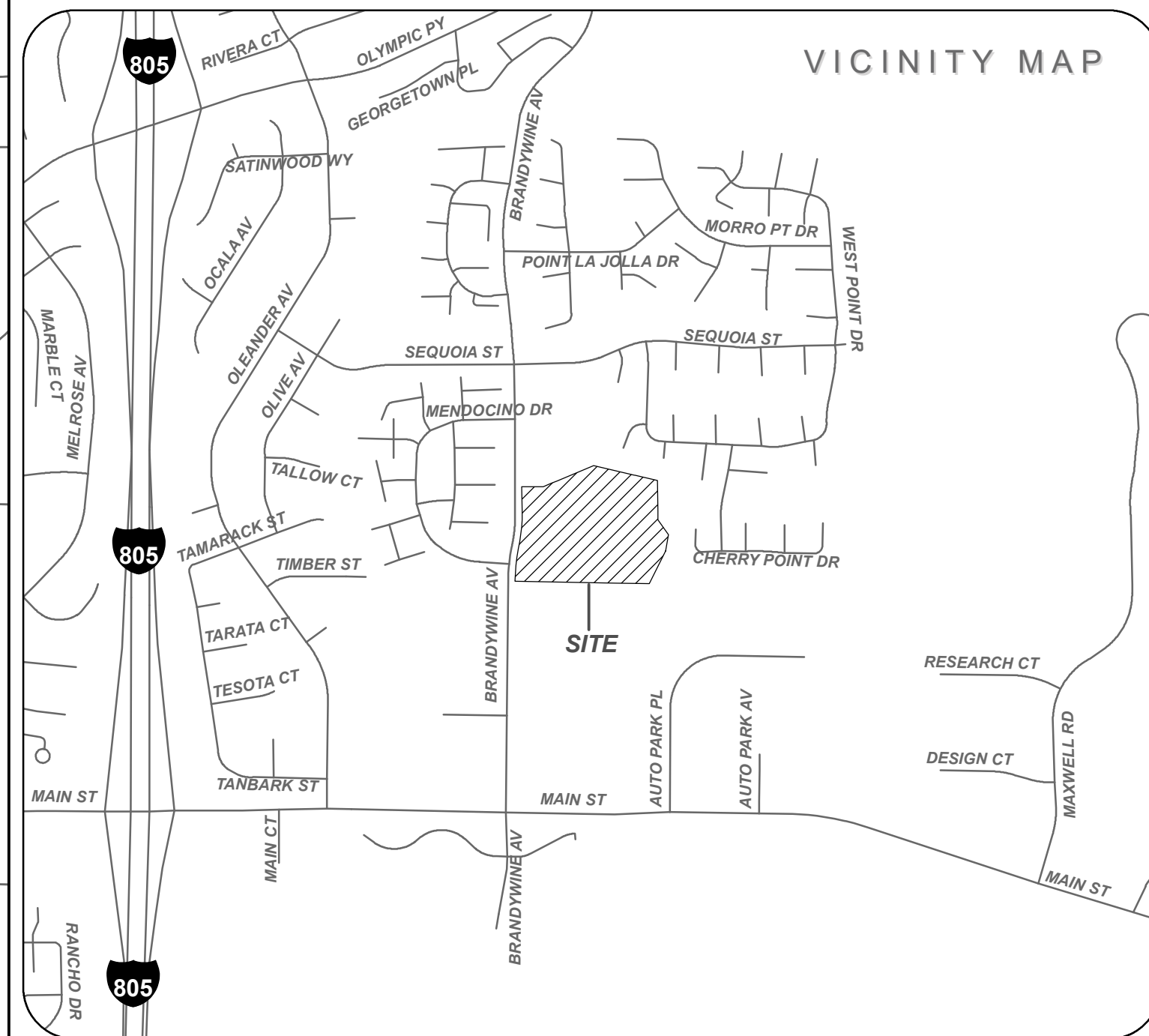

Source: San Diego County GIS
Geographic Coordinate Reference: GCS North American 1983
Projection: NAD 1983 StatePlane California VI FIPS 0406 Feet

