



CLARK
CONSTRUCTION

Building What Matters

Clark Construction Group

Building What Matters

Clark Construction Group is one of the most experienced and respected building and civil construction firms in the United States.

For more than a century, we have been transforming the ideas and visions of our clients into projects that strengthen our communities. We build with the intention of exceeding our clients' expectations for safety, quality, functionality, and aesthetics, and deliver assets that stand the test of time.

We are uncompromising in our pursuit of excellence, and we take great pride in delivering high-quality assets and experiences. We continually find ways to work faster and smarter, respond to challenges with ingenuity and innovation, and earn the trust and respect of our clients and stakeholders. We believe in doing things right the first time, every time, and place value on diligent planning and strong relationships.



A Foundation for How We Build

- Putting Safety First
- Delivering Excellence
- Creating Opportunities for our People
- Acting with Integrity
- Building Inclusive and Diverse Community



A



B

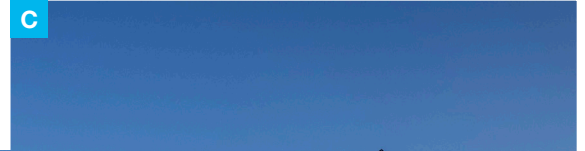

C



F



E



D

FEATURED SAN DIEGO PROJECTS

- A. UCSD North Torrey Pines Living and Learning Neighborhood, La Jolla, CA
- B. Otay Mesa Land Port of Entry, San Diego, CA
- C. Snapdragon Stadium, San Diego, CA
- D. San Diego FBI Field Office, San Diego, CA
- E. Naval Replacement Hospital at Camp Pendleton, Oceanside, CA
- F. SDSU KPBS Expansion and Renovation, San Diego, CA

Building for Breakthroughs

Now more than ever, the pace of research and the teaching of scientific subjects are developing at an exponential pace. New buildings for scientific research, practice, and related engineering and biotechnological facilities evolve just as quickly, requiring more specialized construction capabilities. Building for the sciences is different from the very beginning: highly unique materials, casework, and equipment often require longer procurement periods. As construction progresses, only meticulous quality control can ensure the precision and integrity of the facilities. Clark has developed equally precise and specialized processes for these projects. Our teams always focus on understanding the mission of our client and the facility end-users whose work is so important to scientific innovation.



LABORATORY & RESEARCH PROJECTS

- A. The George Washington University, Science and Engineering Hall, Washington, DC
- B. Argonne Energy Sciences Building, Argonne, IL
- C. University of Kansas, Integrated Science Building, Lawrence, KS

\$3.8B

11M+ SF

Full Breadth of Laboratory Experience

Clark understands the technical, operational, and financial requirements and considerations with each type of facility. We work actively with our laboratory clients, scientists, and designers to build facilities that maximize the program and the quality of the facility within established budgets and schedules. Clark's portfolio of successful laboratory projects spans a full range of facility types:

- ▶ Biosafety Level (BSL) 2 and 3 Laboratories
- ▶ cGMP Manufacturing
- ▶ Class 10/1000/10,000 Cleanrooms
- ▶ Electromagnetic Interference (EMI), Vibration, and Acoustics Sensitivity
- ▶ Environmental Rooms
- ▶ High-Bay Space
- ▶ ISO Cleanrooms 5, 6, and 7
- ▶ Precision Temperature and Humidity Control
- ▶ Vivariums

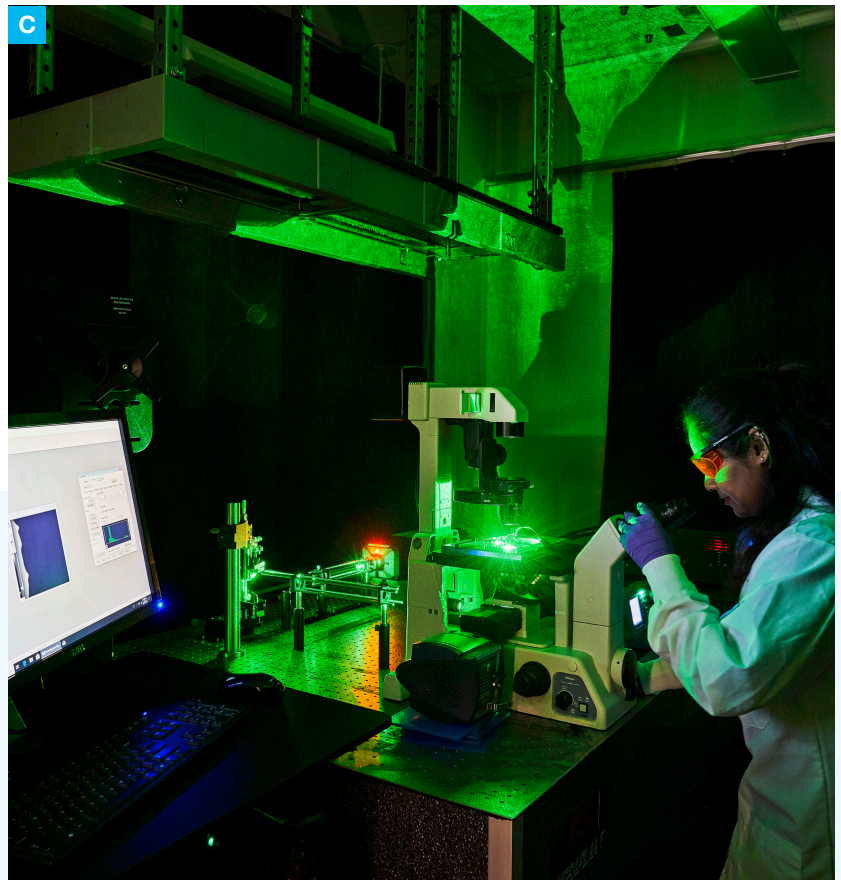

A Full Range of Laboratory Clients

Clark has built many of the nation's top research facilities and laboratories for both public and private clients. We are proud to count among our trusted partners these leading science institutes:

Academic

- ▶ San Diego State University
- ▶ The George Washington University
- ▶ The Johns Hopkins University
- ▶ University of California, Los Angeles
- ▶ University of California, San Francisco
- ▶ University of Kansas
- ▶ University of Maryland
- ▶ Vanderbilt University

Private

- ▶ Takeda Pharmaceuticals

Developer-Led

- ▶ Breakthrough Properties
- ▶ McCarthy Cook
- ▶ Stonebridge
- ▶ Trammell Crow Company

Federal

- ▶ National Institute of Standards and Technology
- ▶ US Food and Drug Administration
- ▶ Argonne National Laboratory
- ▶ US Army Medical Research Institute of Chemical Defense
- ▶ Lawrence Berkeley National Laboratory

UCSF Sandler Neurosciences Center

San Francisco, CA
University of California, San Francisco
237,000 SF / Public-Private Partnership, Design-Build

BSL-2 and BSL-3 Laboratories

Vivarium

Clinical Area

Flexible Research Laboratories

Office Spaces





San Diego State University Engineering & Interdisciplinary Sciences Complex

San Diego, CA
San Diego State University
91,000 SF / Design-Build

- Classrooms
- Wet/Dry Teaching Laboratories
- LEED Gold
- Class 1000 Cleanrooms



Torrey View Life Science Campus

San Diego, CA
Breakthrough Properties
1,000,000 SF / CMAR

Class A Multi-Tenant Life Science Campus

High-End Amenity Spaces LEED Gold Goal

BD Biosciences at Torrey View

San Diego, CA
BD Biosciences
220,000 SF / CMAR

Tenant Fit-Out

Vivarium

Biotech Offices & Laboratories



Lawrence Berkeley National Laboratory BioEPIC Research Building

Berkeley, CA
US Department of Energy
73,000 SF

Academic Research Offices & Laboratories

Biosciences

Earth & Environmental Sciences

LEED Gold Goal



A Leading Education Builder, Dedicated to Serving You

Clark builds educational facilities that inspire creativity and ingenuity, promote the learning process, and strengthen the academic mission of our clients. Among the nation's top education contractors, we have delivered more than 100 academic structures for public and private institutions across the country. Our vast experience in this market, innovative approach to building, and expertise in alternative project delivery — including PPP (P3) and design-build — enables us to bring much-needed facilities to campuses and communities more efficiently and cost effectively than ever before.

Our longstanding partnership with San Diego State University is a testament to our commitment to being a dedicated partner, and to delivering the highest caliber of work at an exceptional cost.



San Diego State University Snapdragon Stadium

San Diego, CA
San Diego State University
35,000-seats

Multi-Use Stadium

Premium Amenity Spaces

LEED Gold





San Diego State University KPBS Modernization & Expansion

San Diego, CA
San Diego State University
67,195 SF

Newsroom

Virtual Studios

Community Space

Administrative & Office Space

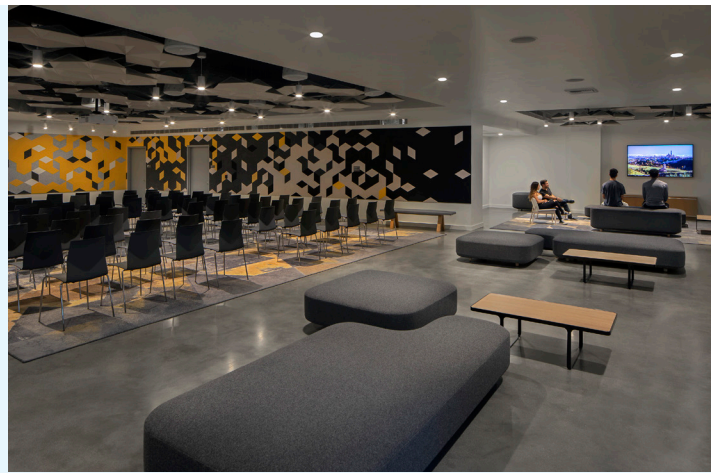

San Diego State University Huāxyacac Hall

San Diego, CA
San Diego State University
200,000 SF

Student Housing

Multi-Purpose Spaces

Faculty Offices

San Diego State University Mission Valley Site Development

San Diego, CA
San Diego State University

Project Infrastructure

Mixed-Use

Transit-Oriented Development





- ▶ 30 Years with Clark
- ▶ 30 Years in the AEC Industry
- ▶ B.S., Building Construction, University of Florida
- ▶ Juris Doctor, Whittier Law School



Jim McLamb

Senior Vice President | Regional Executive Officer

Jim oversees all San Diego operations and administration by leveraging the strength of the whole organization while employing the leanness, agility, and culture of a smaller, local company. He is accountable for day-to-day operations, including execution of work and oversight of Clark's most precious resource—its people. Jim will make certain that appropriate resources are made available to ensure success of the Millenia project.

SDSU Snapdragon Stadium and Mission Valley Site Development

San Diego, CA / 160 Acres / \$450M / 2023 / Progressive Design-Build

Regional Executive Officer

Clark led the design and construction of SDSU's new multi-use stadium and development of the 160-acre site in preparation for the new SDSU West campus. The 35,000-seat stadium serves as the new home for the SDSU Aztec football team, professional soccer, NCAA championship games, and concerts. SDSU West will be a vibrant, mixed-use, transit-oriented development that will include retail, housing, and 80 acres of community parks and open space, including a 34-acre river park.

Torrey View Life Science Campus

San Diego, CA / 515K SF / \$239M / 2023 / CM at-Risk

Regional Executive Officer

Clark is constructing a new commercial life sciences campus on a 10-acre site featuring three R & D buildings, a tenant clubhouse, and a below-grade parking structure. High-end amenity spaces include multiple dining options, a fitness center, pickle ball courts, and surfboard and bike storage. Clark was also contracted to build the first tenant fitout at Torrey View for BD Biosciences.

Renovation of Various Buildings at Vandenberg Space Force Base (VSFB)

Santa Barbara County, CA / 41K SF / \$69M / 2022 / Design-Build

Regional Executive Officer

Clark is providing design-build services to Northrop Grumman at the VSFB. The project utilizes both traditional construction methods and prefabricated modular units to create one- and two-story office, laboratory spaces, and a battery storage facility. The spaces are constructed to comply with strict security requirements for classified government operations.



- ▶ 14 Years with Clark
- ▶ 22 Years in the AEC Industry
- ▶ B.S., General Building, Construction, Arizona State University
- ▶ LEED AP
- ▶ Safety Trained Supervisor (STS)



Albert Valdivia

Vice President | Executive-in-Charge

Albert is responsible for achieving the project goals through consistent communication and coordination with Chesnut Properties, the design team, and Clark's management team throughout all phases of design and construction. With access to Clark's full range of corporate resources, he will ensure that the project receives the personnel and equipment required to meet stated project objectives.

SDSU Engineering & Interdisciplinary Sciences (EIS) Complex

San Diego, CA / 91K SF / \$75M / 2017 / Progressive Design-Build

Project Executive

Clark provided design-build services for the state-of-the-art science and engineering building, comprised of both wet and dry laboratories and flexible research space to accommodate a range of STEM programs. The building features a clean lab that provides ISO 6 (Class 1,000) clean space pressurized by a high-performance mechanical system. Located just south of the existing engineering building, which is connected by a bridge to the new facility, EIS was delivered 25 days ahead of schedule and became the fastest design to completion duration that SDSU has ever achieved.

SDSU Snapdragon Stadium and Mission Valley Site Development

San Diego, CA / 160 Acres / \$450M / 2023 / Progressive Design-Build

Vice President/Executive-in-Charge

Clark led the design and construction of SDSU's new multi-use stadium and development of the 160-acre site in preparation for the new SDSU West campus. The 35,000-seat stadium serves as the new home for the SDSU Aztec football team, professional and collegiate soccer, NCAA championship games, concerts, and other events. SDSU West will be a vibrant, mixed-use, transit-oriented development that will include transit, retail, housing, and more than 80 acres of community parks and open space, including a 34-acre river park.

SDSU Huāxyacac Hall

San Diego, CA / 200K SF / \$114M / 2019 / Progressive Design-Build

Project Executive

Clark provided design-build services for a new residence hall that houses more than 1,100 first-year students configured in double, triple, and quadruple occupancy rooms. The new Freshman Housing complex is a significant addition to SDSU's student life program and features multi-purpose spaces, faculty offices, study areas, and student lounges. Delivered on time and on budget, the project offers modern amenities, including a market, café, community center, communal kitchen, courtyard, and an outdoor plaza for food trucks and farmer's market vendors.



Andy Armstrong

Vice President | Construction Executive

- ▶ 20 Years with Clark
- ▶ 24 Years in the AEC Industry
- ▶ Member, AGC Construction Leadership Council
- ▶ Safety Trained Supervisor (STS)
- ▶ OSHA 30-Hour Trained
- ▶ SDSU Lean Enterprise Certified
- ▶ SWPPP Compliance Certified
- ▶ Engineers Manual 385 (EM385) Certified

Andy provides senior leadership to Clark's field activities for all projects in San Diego. He has ultimate responsibility for all field operations, including developing the project plan and master construction schedule; leading the project team during construction execution, on schedule, within budget, safely, and in compliance with the plans and specifications; executing the quality control program; site safety plan, and commissioning plan; and, managing the activities of all field employees and trade partners.

Torrey View

San Diego, CA / 515K SF / \$239M / 2023 / CM at-Risk

Construction Executive

Clark is constructing a new commercial life sciences development on a 10-acre site that will consist of three research and development buildings, a tenant clubhouse, and a below-grade parking structure. High-end amenity spaces will include multiple dining options, a fitness center, pickleball courts, and surfboard and bike storage. The project is designed to achieve LEED Gold certification.

BD Biosciences Fitout at Torrey View

San Diego, CA / 211K SF / \$75M / 2023 / CM at-Risk

Construction Executive

Clark is providing preconstruction and CM services for a tenant fitout for BD Biosciences at Torrey View, a 10-acre commercial life sciences development currently under construction by Clark. BD Biosciences will occupy the largest of three research and development buildings on the campus, which also includes a tenant clubhouse. The tenant improvement will feature approximately 100,000-SF of laboratory space with a vivarium on the first floor, office and support space, serving as home for an expanded San Diego Reagent Innovation Center for the company's growing biosciences business.

SDSU Snapdragon Stadium and Mission Valley Site Development

San Diego, CA / 205K SF / \$451M / 2023 / Design-Build

Construction Executive

Clark led the design and construction of San Diego State University's new multi-use stadium, situated on the 160-acre SDSU West campus. The new 35,000-seat stadium serves as the new home for the SDSU collegiate sports teams, NCAA championship games, concerts and other events. The stadium is part of the first phase of SDSU's campus expansion in Mission Valley, a 1.6-million-square-foot campus expansion located adjacent to the stadium.



- ▶ 15 Years with Clark
- ▶ 19 Years in the AEC Industry
- ▶ B.S., Construction Management, Wentworth Institute of Technology
- ▶ LEED AP
- ▶ Safety Trained Supervisor (STS)
- ▶ OSHA 10-Hour Trained



Scott Wentworth

Preconstruction Executive

Scott will draw from his experience leading preconstruction on the SDSU EIS Complex and Torrey View Life Science Campus to develop and coordinate conceptual, schematic, and design development estimates, and provide budget updates and preconstruction management during project development. He will manage the value analysis process and product selection during design and participate in regular discussions with Chesnut Properties and the design team to evaluate changes in scope.

SDSU Engineering & Interdisciplinary Sciences (EIS) Complex

San Diego, CA / 91K SF / \$75M / 2017 / Progressive Design-Build

Preconstruction Manager

Clark provided design-build services for the state-of-the-art science and engineering building comprised of both wet and dry labs and flexible research space to accommodate a range of STEM programs. The building features a clean lab that provides ISO 6 (Class 1,000) clean space pressurized by a high-performance mechanical system. Connected by a bridge to the adjacent existing engineering building, EIS was delivered 25 days ahead of schedule and became the fastest design to completion duration that SDSU has ever achieved.

Torrey View Life Science Campus

San Diego, CA / 515K SF / \$239M / 2023 / CM at-Risk

Preconstruction Executive

Clark is constructing a new commercial life sciences development on a 10-acre site featuring three research and development buildings, a tenant clubhouse, and a below-grade parking structure. High-end amenity spaces include multiple dining options, a fitness center, pickle ball courts, and surfboard and bike storage. Scott is concurrently leading preconstruction for the first tenant fitout at Torrey View. BD Biosciences will occupy the largest of Torrey View's R&D buildings for their San Diego Reagent Innovation Center. The \$75 million TI will feature 100,000 SF of laboratory space with a vivarium on the first floor, office, and support space.

SDSU Snapdragon Stadium

San Diego, CA / 205K SF / \$267M / 2022 / Progressive Design-Build

Project Executive

Clark led the design and construction of San Diego State University's new multi-use stadium, situated on the 160-acre SDSU West campus. The new 35,000-seat stadium serves as the new home for the SDSU Aztec football team, collegiate football, professional and collegiate soccer, NCAA championship games, concerts and other events. The LEED Gold stadium is part of the first phase of San Diego State University's campus expansion in Mission Valley.



Wendy Bohn

Project Executive

Wendy brings a dynamic, innovative, and critical thinking point of view with strong skills in assessing and balancing the parameters of design, specification, schedule, and cost. Wendy brings expertise in identifying and mitigating risks, and uncovering and vetting opportunities for delivering efficiencies and acceleration that will be vital in providing successful project oversight for the Millenia project.

- ▶ 14 Years with Clark
- ▶ 16 Years in the AEC Industry
- ▶ B.S. Construction Engineering, San Diego State University
- ▶ LEED AP, BD+C
- ▶ Safety Trained Supervisor in Construction (STSC)
- ▶ OSHA 30-Hour Trained

SDSU Engineering & Interdisciplinary Sciences (EIS) Complex

San Diego, CA / 91K SF / \$75M / 2017 / Progressive Design-Build

Senior Project Manager

Clark provided design-build services for the state-of-the-art science and engineering building, comprised of both wet and dry laboratories and flexible research space to accommodate a range of STEM programs. The building features a clean lab that provides ISO 6 (Class 1,000) clean space pressurized by a high-performance mechanical system. Located just south of the existing engineering building, which is connected by a bridge to the new facility, EIS was delivered 25 days ahead of schedule and became the fastest design to completion duration that SDSU has ever achieved.

SDSU Huāxyacac Hall

San Diego, CA / 200K SF / \$114M / 2019 / Progressive Design-Build

Senior Project Manager

Clark provided design-build services for a new residence hall that houses more than 1,100 first-year students configured in double, triple, and quadruple occupancy rooms. The new Freshman Housing complex is a significant addition to SDSU's student life program and features multi-purpose spaces, faculty offices, study areas, and student lounges. Delivered on time and on budget, the project offers modern amenities, including a market, café, community center, communal kitchen, courtyard, and an outdoor plaza for food trucks and farmer's market vendors.

Renovation of Various Buildings at Vandenberg Space Force Base (VSFB)

Santa Barbara County, CA / 41K SF / \$69M / 2022 / Design-Build

Project Executive

Clark is providing design-build services to Northrop Grumman at the VSFB. The project utilizes both traditional construction methods and prefabricated modular units to create one- and two-story office, laboratory spaces, and a battery storage facility. The spaces are constructed to comply with strict security requirements for classified government operations.



Matt Gerard

Project Executive

- ▶ 21 years with Clark
- ▶ 21 years in the AEC Industry
- ▶ BS, Civil Engineering, San Diego State University
- ▶ Design-Build Professional (DBIA)
- ▶ LEED AP
- ▶ OSHA 30-Hour Trained
- ▶ Safety and First-Aid Trained Supervisor (STS)

Matt started working for Clark as an intern on the Manchester Grand Hyatt Hotel and CALTRANS District 11 Replacement Office Building while working toward his Civil Engineering degree at San Diego State University. He was hired as a Project Engineer upon graduation, and has climbed the ranks over the last two decades serving as a Project Engineer, Project Manager, Senior Project Manager, and Project Executive. A leader in San Diego, Matt has managed large, complex, multi-phased projects, most recently the new Snapdragon Stadium for San Diego State University.

SDSU Snapdragon Stadium

San Diego, CA / 205K SF / \$267M / 2022 / Progressive Design-Build

Project Executive

Clark led the design and construction of San Diego State University's new multi-use stadium, situated on the 160-acre SDSU West campus. The new 35,000-seat stadium serves as the new home for the SDSU Aztec football team, collegiate football, professional and collegiate soccer, NCAA championship games, concerts and other events. The LEED Gold stadium is part of the first phase of San Diego State University's campus expansion in Mission Valley.

SDSU Engineering & Interdisciplinary Sciences (EIS) Complex

San Diego, CA / 91K SF / \$75M / 2017 / Progressive Design-Build

Project Executive

Clark provided design-build services for the state-of-the-art science and engineering building comprised of both wet and dry labs and flexible research space to accommodate a range of STEM programs. The building features a clean lab that provides ISO 6 (Class 1,000) clean space pressurized by a high-performance mechanical system. Connected by a bridge to the adjacent existing engineering building, EIS was delivered 25 days ahead of schedule and became the fastest design to completion duration that SDSU has ever achieved.

Dignity Health Northridge Hospital Medical Center, F-Tower and F-Elevator Tower Building Seismic Upgrades

Northridge, CA / 101K SF / \$56M / 2016 / Design-Build

Senior Project Manager

Clark provided design-build services for the seismic retrofit of the Northridge Hospital Medical Center, bringing the F-Tower and F-Tower Elevator Tower into compliance with California SB1953 regulations. In addition to seismically upgrading the facility, the hospital opted to renovate or build-out several new units. The largest component of the improvement scope is the construction of a new five-story, two-cab elevator tower to be built between two existing towers.



Clark Construction Group - CA, LP

clarkconstruction.com

Offices

Baltimore, MD
Bethesda, MD
McLean, VA
Richmond, VA
Chicago, IL
Nashville, TN
Atlanta, GA
Houston, TX
Irvine, CA
Los Angeles, CA
San Diego, CA
San Francisco, CA
Seattle, WA

San Diego

525 B Street, Suite 250
San Diego, CA 92101

(619) 578-2650