



Project No. 07516-42-02
April 24, 2023

Tri Pointe Homes
13520 Evening Creek Drive North, Suite 300
San Diego, California 92128

Attention: Mr. Allen Kashani

Subject: RESPONSE TO CITY OF SAN DIEGO REVIEW COMMENTS
NAKANO
SAN DIEGO, CALIFORNIA

- References:
1. City of San Diego Geology Review Comments prepared by Kreg Mills, dated April 20, 2021.
 2. *Update Geotechnical Investigation, Nakano Property, Chula Vista, California* prepared by Geocon Incorporated dated September 18, 2020 (Project No. 07516-42-02).
 3. *Nakano, Grading and Storm Drain*, prepared by Civil Sense, Inc., dated May 12, 2022.

Dear Mr. Kashani:

We prepared this letter to respond to City of San Diego LDR-Geology review comments for the subject project. The review comments pertaining to geotechnical aspects and our responses are presented below.

Issue 15: *The project's geotechnical consultant must submit a geotechnical addendum or update letter for the purpose of an environmental review that specifically addresses the proposed development plans and the following:*

Response: Based on our review of the referenced plans, the recommendations presented in our Update Geotechnical Investigation (Reference 2) remain applicable. This response serves as the requested addendum/update report.

Issue 16: *The limits of the proposed development appear to have changed since the submitted report was prepared. Provide an updated Geologic Map (Figure 2) that shows the current proposed development. Circumscribe the limits of anticipated remedial grading on the updated map to delineate the proposed footprint of the project.*

Response: Figure 1 is the requested updated geologic map using a CAD file of Reference 3 as the base map. Figure 1 shows the proposed development and the disturbance limits and limits of anticipated remedial grading. Cross sections are provided on Figures 2 and 3.

Issue 17: *Indicate if additional recommendations and/or conclusions are needed to address the revisions to the development plans.*

Response: No additional geotechnical recommendations and/or conclusions are needed.

Issue 18: *Indicate if the approximate limits of remedial grading currently shown on the revised development plans are in accordance with their recommendations.*

Response: Along the northern property margin, the limits shown on the development plan did not match those shown on our geologic map. The civil engineer is revising the development plan to reflect the limits provided on Figure 1 of this letter.

If there are any questions regarding this correspondence, or if we may be of further service, please contact the undersigned at your convenience.

Very truly yours,

GEOCON INCORPORATED



Rodney C. Mikesell
GE 2533



RCM:arm

(e-mail) Addressee
(e-mail) Civil Sense, Inc.
Attention: Ms. Maykia Vang

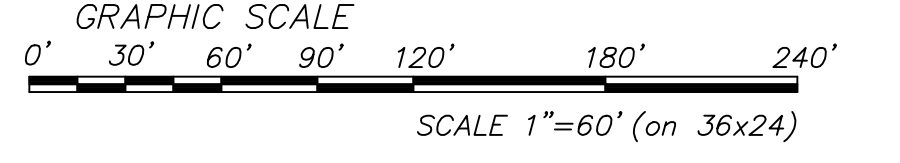
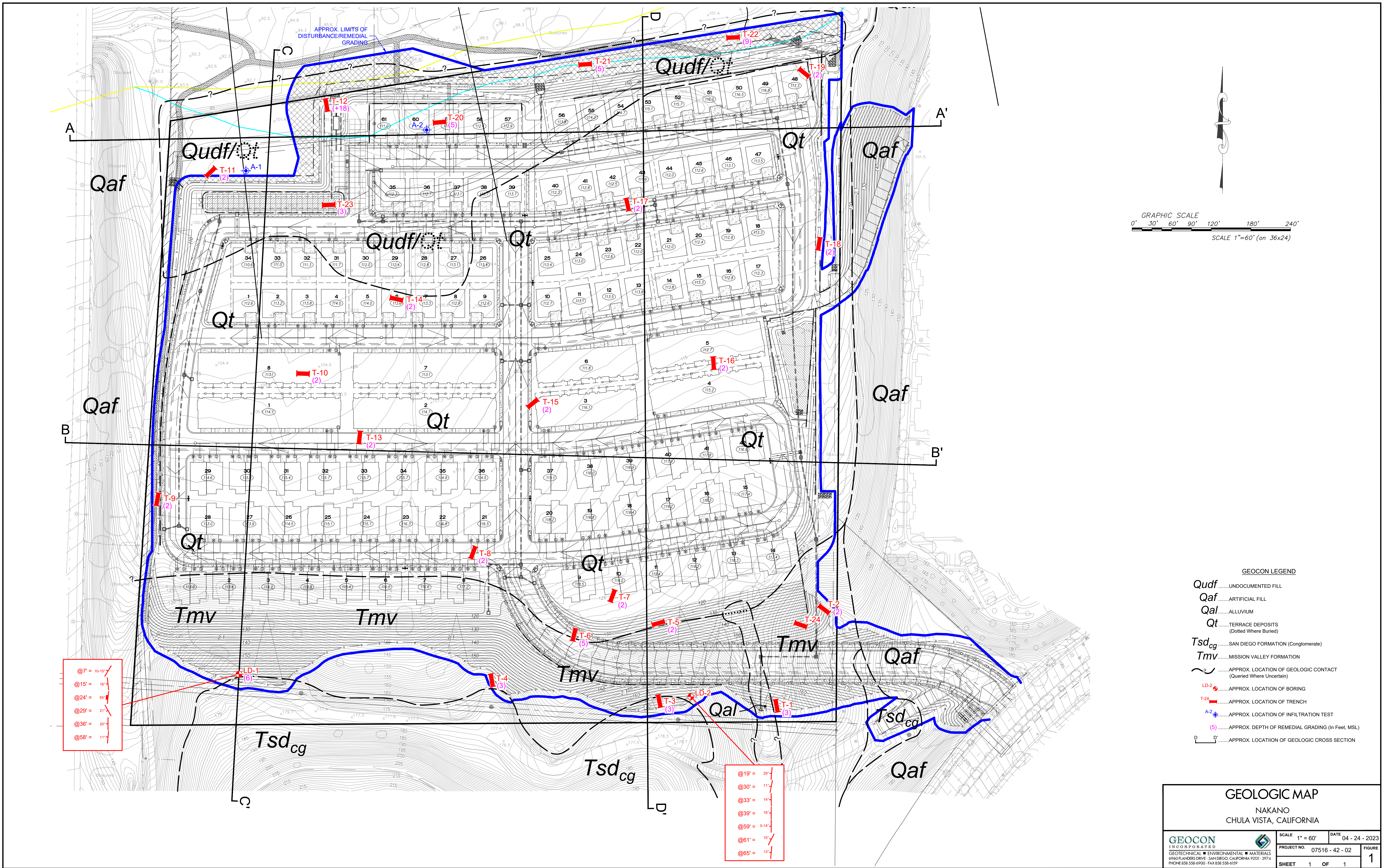

GEOCON LEGEND

- Qudf* UNDOCUMENTED FILL
- Qaf* ARTIFICIAL FILL
- Qal* ALLUVIUM
- Qt* TERRACE DEPOSITS
(Dotted Where Buried)
- Tsd_{cg}* SAN DIEGO FORMATION (Conglomerate)
- Tmv* MISSION VALLEY FORMATION
- APPROX. LOCATION OF GEOLOGIC CONTACT
(Queried Where Uncertain)
- LD-2 APPROX. LOCATION OF BORING
- T-24 APPROX. LOCATION OF TRENCH
- A-2 APPROX. LOCATION OF INFILTRATION TEST
- (5) APPROX. DEPTH OF REMEDIAL GRADING (in Feet, MSL)
- D-D' APPROX. LOCATION OF GEOLOGIC CROSS SECTION

- @7' = 10-15'
- @15' = 16'
- @24' = 65'
- @29' = 21'
- @36' = 20'
- @58' = 11'

- @19' = 29'
- @30' = 11'
- @33' = 14'
- @39' = 16'
- @59' = 0-14'
- @61' = 10'
- @65' = 13'

GEOLOGIC MAP
NAKANO
CHULA VISTA, CALIFORNIA

GEOCON INCORPORATED <small>GEOTECHNICAL ■ ENVIRONMENTAL ■ MATERIALS</small> <small>6940 SANDERS DRIVE ■ SAN DIEGO, CALIFORNIA 92121-2974</small> <small>PHONE 858.558.4900 ■ FAX 858.558.6159</small>	SCALE 1" = 60'	DATE 04 - 24 - 2023
	PROJECT NO. 07516 - 42 - 02	FIGURE 1
	SHEET 1 OF 1	

Revised: 04/24/2023 12:28PM | By: ALVIN LADRILLANO | File Location: Y:\PROJ\07516-42-02 (Nakano)\SHEETS\07516-42-02-01 Map 50.dwg

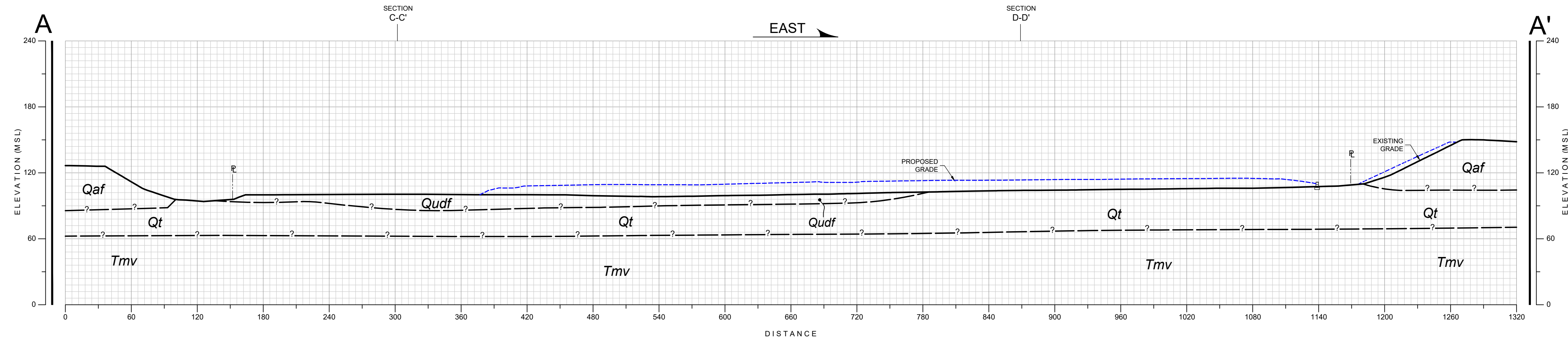

GEOLOGIC CROSS-SECTION A-A'
SCALE: 1" = 60' (Vert. = Horiz.)

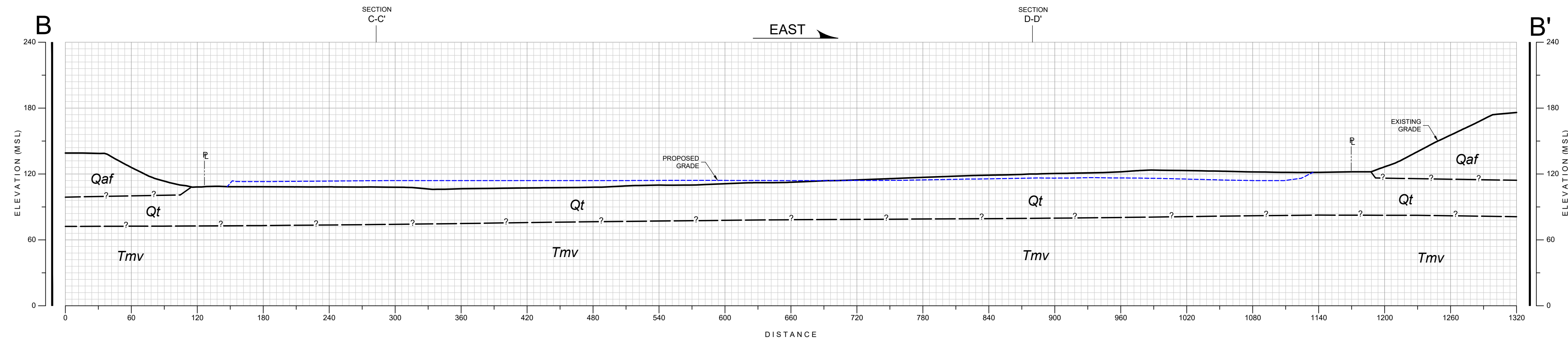

GEOLOGIC CROSS-SECTION B-B'
SCALE: 1" = 60' (Vert. = Horiz.)

- GEOCON LEGEND**
- Qudf* UNDOCUMENTED FILL
 - Qaf* ARTIFICIAL FILL
 - Qt* TERRACE DEPOSITS
 - Tmv* MISSION VALLEY FORMATION
 - ~?~ APPROX. LOCATION OF GEOLOGIC CONTACT
(Queried Where Uncertain)

GEOLOGIC CROSS SECTION			
NAKANO CHULA VISTA, CALIFORNIA			
GEOCON INCORPORATED <small>GEOTECHNICAL ■ ENVIRONMENTAL ■ MATERIALS</small> 6940 SANDERS DRIVE ■ SAN DIEGO, CALIFORNIA 92121-2974 PHONE 858.558.4900 ■ FAX 858.558.4159	SCALE 1" = 60'	DATE 04 - 24 - 2023	2
	PROJECT NO. 07516 - 42 - 02	FIGURE	
SHEET 1 OF 2			

Printed: 04/24/2023 12:52PM | By: ALVIN LADRILLON | File Location: Y:\PROJECTS\07516-42-02 (Nakano)\SHEETS\07516-42-02 (Section) 00.dwg

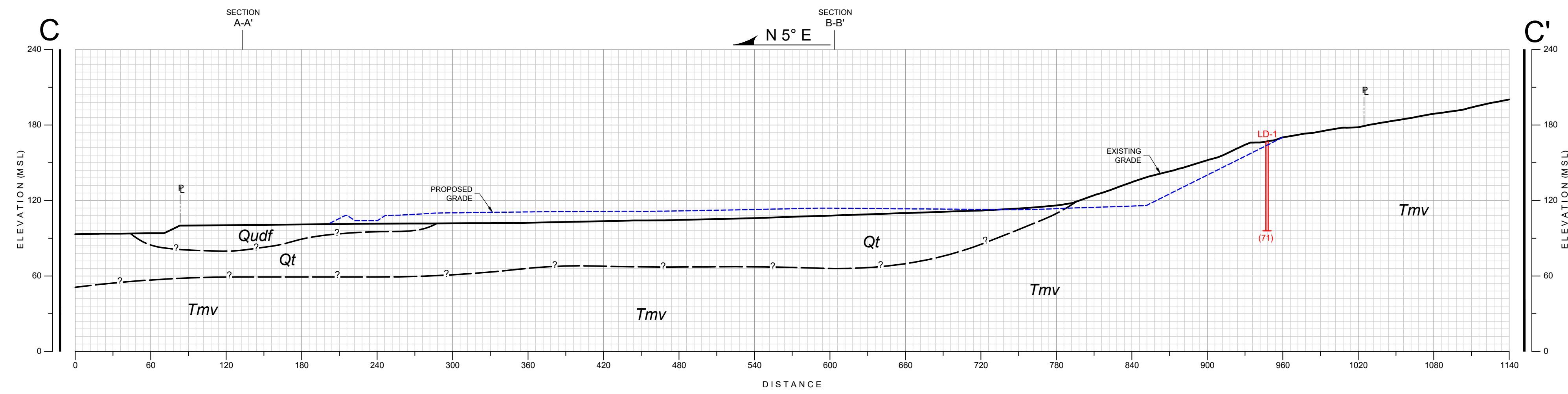

GEOLOGIC CROSS-SECTION C-C'
SCALE: 1" = 60' (Vert. = Horiz.)

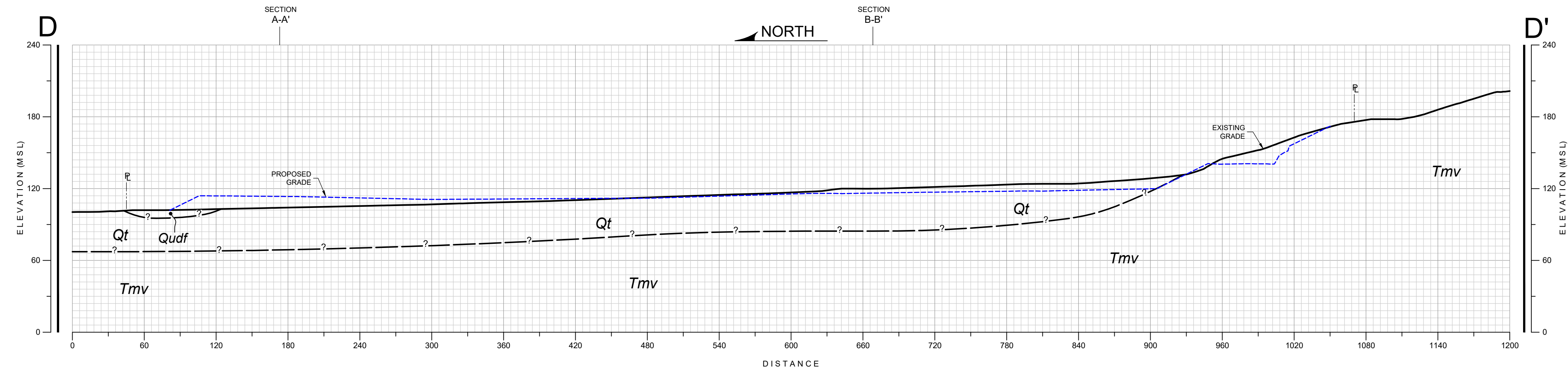

GEOLOGIC CROSS-SECTION D-D'
SCALE: 1" = 60' (Vert. = Horiz.)

- GEOCON LEGEND**
- Qudf* UNDOCUMENTED FILL
 - Qaf* ARTIFICIAL FILL
 - Qt* TERRACE DEPOSITS
 - Tmv* MISSION VALLEY FORMATION
 - ~? APPROX. LOCATION OF GEOLOGIC CONTACT (Queried Where Uncertain)

GEOLOGIC CROSS SECTION			
NAKANO CHULA VISTA, CALIFORNIA			
GEOCON <small>INCORPORATED</small> GEOTECHNICAL ■ ENVIRONMENTAL ■ MATERIALS 6940 RANDERS DRIVE ■ SAN DIEGO, CALIFORNIA 92121-2974 PHONE 858.558.4900 ■ FAX 858.558.4159	SCALE 1" = 60'	DATE 04 - 24 - 2023	3
	PROJECT NO. 07516 - 42 - 02	FIGURE	
	SHEET 2 OF 2		

Plotfile:04242023 12:52PM | By ALVIN LADRILLON | File Location: Y:\PROJECTS\07516-42-02 (Nakano)\SHEET\07516-42-02 (Section-00.dwg)